

# UNION TOWNSHIP SECTION 6 R 13 TWP 8 MORGAN COUNTY, OHIO

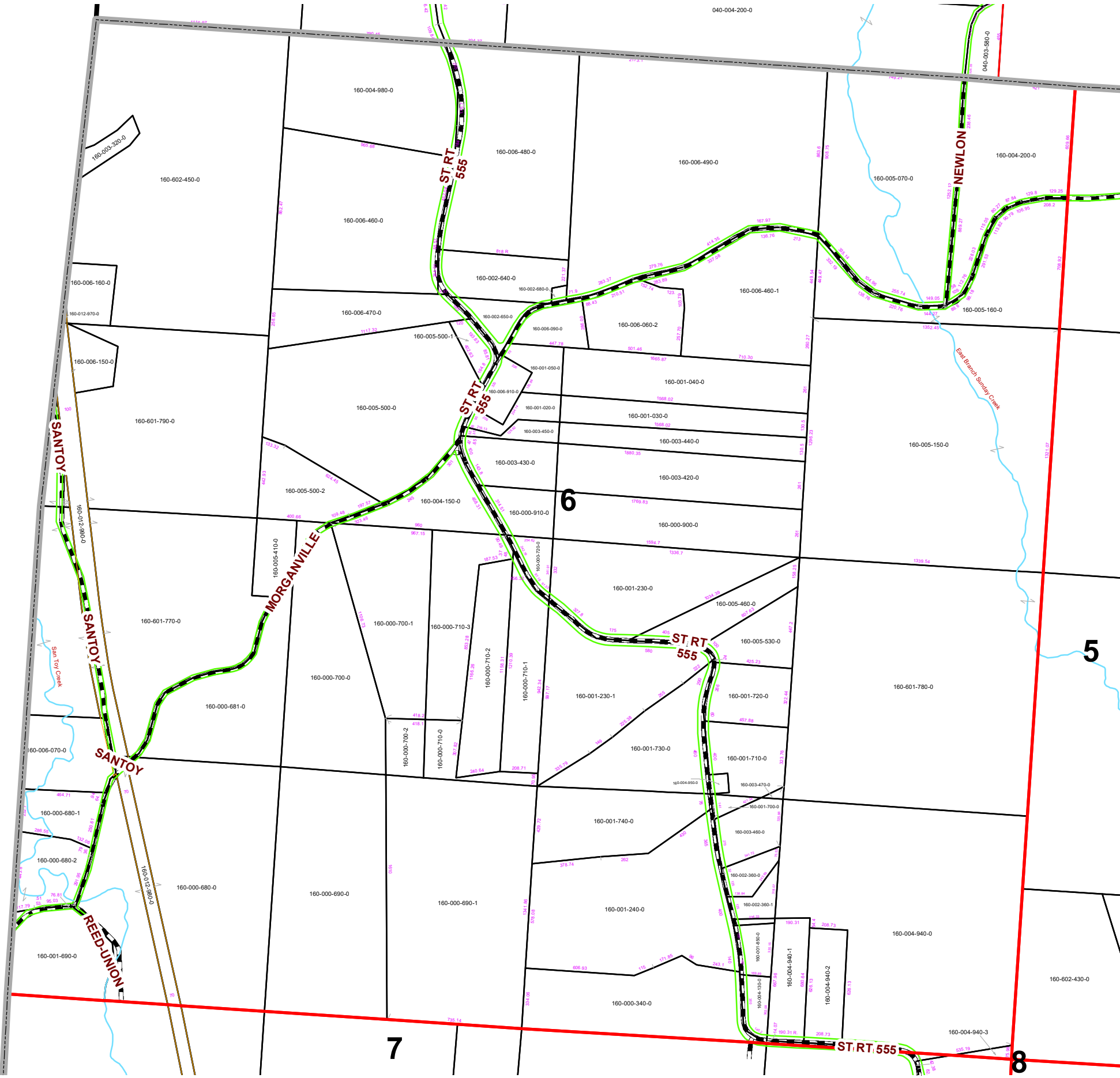

PIN	Owner	LegalDescr	Acres	VOL	PAGE	Survey_Ref
160-004-940-0	BANKES CARL E & PATRICIA M	R13 T08 S06 SD 14 SUR	33.891	OR138	245	NoSurvey.pdf
160-004-950-0	BANKES CARL E & PATRICIA M	R13 T08 S06 SD 29 SUR	0.25	OR160	789	NoSurvey.pdf
160-006-150-0	BLACKHAWK LAND & RESOURCES LL	R13 T08 S06 SD 27 EX	2.28	OR223	170	NoSurvey.pdf
160-006-160-0	BLACKHAWK LAND & RESOURCES LL	R13 T08 S06 SD 24 EX	1.94	OR223	153	NoSurvey.pdf
160-004-940-2	BOTTERILL GAYLE ANN	R13 T08 S06 SD 68	3	OR232	1702	UNN-0171.pdf
160-000-700-1	CORP GENE & MELISSA	R13 T08 S06 SD 71 SUR	9.366	OR50	542	UNN-0190.pdf
160-000-710-3	CORP GENE & MELISSA R	R13 T08 S06 SD 70 SUR	6.124	OR50	542	UNN-0190.pdf
160-000-710-2	CORP GENE & MISSY	R13 T08 S06 SD 65	5.547	OR7	245	UNN-0147.pdf
160-000-710-1	CORP LAWRENCE E & MELISSA R	R13 T08 S06 SD 64 SUR	5.036	OR206	179	UNN-0124.pdf
160-006-910-0	CORP LAWRENCE E & MELISSA R	R13 T08 S06 SD 40	1.49	OR224	2121	UNN-0029A.pdf
160-001-740-0	CORP RICK & TAMARA K	R13 T08 S06 SD 59 EX	7	OR233	1066	UNN-0070.pdf
160-001-730-0	CORP RICK & TAMARA K	R13 T08 S06 SD 58 EX	7.474	OR233	1066	UNN-0070.pdf
160-000-690-1	CORP RICK E & TAMARA	R13 T08 S06 SD 74 SUR	23.634	OR62	712	UNN-0141.pdf
160-000-710-0	CORP RICK E & TAMARA	R13 T08 S06 SD 11 SUR	1.931	OR62	712	UNN-0141.pdf
160-000-700-2	CORP RICK E & TAMARA	R13 T08 S06 SD 73 SUR	1.507	OR62	712	UNN-0141.pdf
160-000-680-0	CORP RICK E & TAMARA K	R13 T08 S06 SD 9 EX C	27.442	OR164	690	UNN-0205.pdf
160-000-690-0	CORP RICK E & TAMARA K	R13 T08 S06 SD 12 EX	17.182	OR164	690	UNN-0205.pdf
160-000-681-0	CORP RICK E & TAMARA K	R13 T08 S06 SD 75	10.414	OR164	690	UNN-0205.pdf
160-000-700-0	CORP RICK E & TAMARA K	R13 T08 S06 SD 25	10.436	OR164	690	NoSurvey.pdf
160-001-240-0	CORP RICK E & TAMARA KAY	R13 T80 S06 SD 23	16.893	D.V 200	515	UNN-0082.pdf
160-004-980-0	CROWLEY PATRICK L & MELINDA S	R13 T08 S06 SD 41 SUR	9.97	OR210	1448	UNN-0036.pdf
160-000-900-0	DAMRON HASSEL W	R13 T08 S06 SD 34	8	OR214	216	UNN-0029A.pdf
160-000-910-0	DAMRON HASSEL W	R13 T08 S06 SD 35	2.08	OR214	216	UNN-0029A.pdf
160-002-360-1	DRONE DEBORAH	R13 T08 S06 SD 76	1	OR112	524	UNN-0232.pdf
160-001-850-1	DRONE DEBORAH	R13 T8 S6 SD81	0.16	OR235	2087	UNN-0354.pdf
160-001-690-0	EING JAMES L	R13 T08 S06 SD 10 EX	4	D.V 171	181	NoSurvey.pdf
160-001-230-1	EL TRINGHAM ALAN & CAROL	R13 T08 S06 SD 63	10.099	D.V 200	705	UNN-0118.pdf
160-001-020-0	GARDNER RACHAEL DIANE & SCOT T	R13 T08 S06 SD 56 EX	1.221	OR226	1079	UNN-0067.pdf
160-001-030-0	GARDNER RACHAEL DIANE & SCOT T	R13 T08 S06 SD 57 EX	3.955	OR226	1079	UNN-0067.pdf
160-001-040-0	GARDNER RACHAEL DIANE & SCOT T	R13 T08 S06 SD 42 SUR	8	OR226	1079	UNN-0029A.pdf
160-001-050-0	GARDNER RACHAEL DIANE & SCOT T	R13 T08 S06 SD 43 SUR	1.48	OR226	1079	UNN-0029A.pdf
160-001-850-0	GARRETT PAUL H	R13 T08 S06 SD 48 EX	1.24	D.V 165	551	UNN-0052.pdf
160-002-640-0	HAVENS JAMES H	R13 T08 S06 SD 17 EX	3.84	OR230	2606	UNN-0285.pdf
160-002-650-0	HAVENS JAMES H & MARY M	R13 T08 S06 SD 18 EX	1.25	OR230	2606	NoSurvey.pdf
160-002-680-0	HENERY WADE & OSBORNE CLIFFORD	R13 T08 S06 SD 30	0.16			NoSurvey.pdf
160-005-500-1	HOOPER BEULA B	R13 T08 S06 SD 67	1.051	OR140	334	UNN-0152.pdf
160-001-230-0	JENKINS ZACHARY T	R13 T08 S06 SD 22 SUR	10.05	OR232	4618	UNN-0120.pdf
160-012-980-0	JUDSON RAY	R13 T08 S06 SD 60	3.09	OR228	1328	NoSurvey.pdf
160-012-990-0	JUDSON RAY	R13 T08 S06 SD 61	5.29	OR228	1331	NoSurvey.pdf
160-006-060-2	KITTS JOHN SCOTT	R13 T08 S06 SD 80	4.341	OR225	1102	UNN-0307B.pdf
160-003-320-0	LANPHERE EVELYN D & CHARLES A	R13 T08 S06 SD 26 EX	0.98	OR209	2818	NoSurvey.pdf
160-005-530-0	LEE CONNIE S & BERQUIST DIANNA	R13 T08 S06 SD 54 EX	2.96	OR234	2689	UNN-0058.pdf
160-000-680-1	LENQYEL JOHN	R13 T08 S06 SD 77	2.613	OR113	413	UNN-0231.pdf
160-003-460-0	LESTER CAROL	R13 T08 S06 SD 50 EX	2.29	D.V 165	547	UNN-0054.pdf
160-003-470-0	LESTER CAROL	R13 T08 S06 SD 51 EX	0.12			UNN-0054.pdf

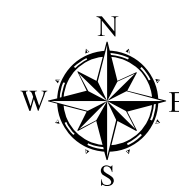

**Boundaries**

- Hydro
- Section
- Roads
- Lot
- - - Township
- County
- Parcel
- ROW



Disclaimer: The information that these maps contains is for reference purposes only. Please bring any erros to the attention of the Engineer's Office staff. Thank you

Source: Morgan County Engineer's Office  
 Author: Marcia Wolfe  
 Date: 02/10/20

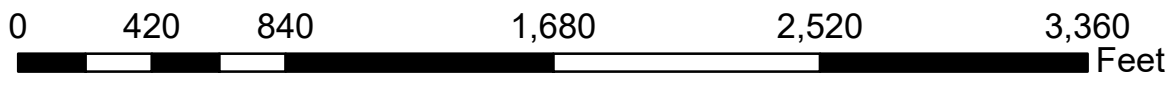

# UNION TOWNSHIP SECTION 6 R 13 TWP 8 MORGAN COUNTY, OHIO

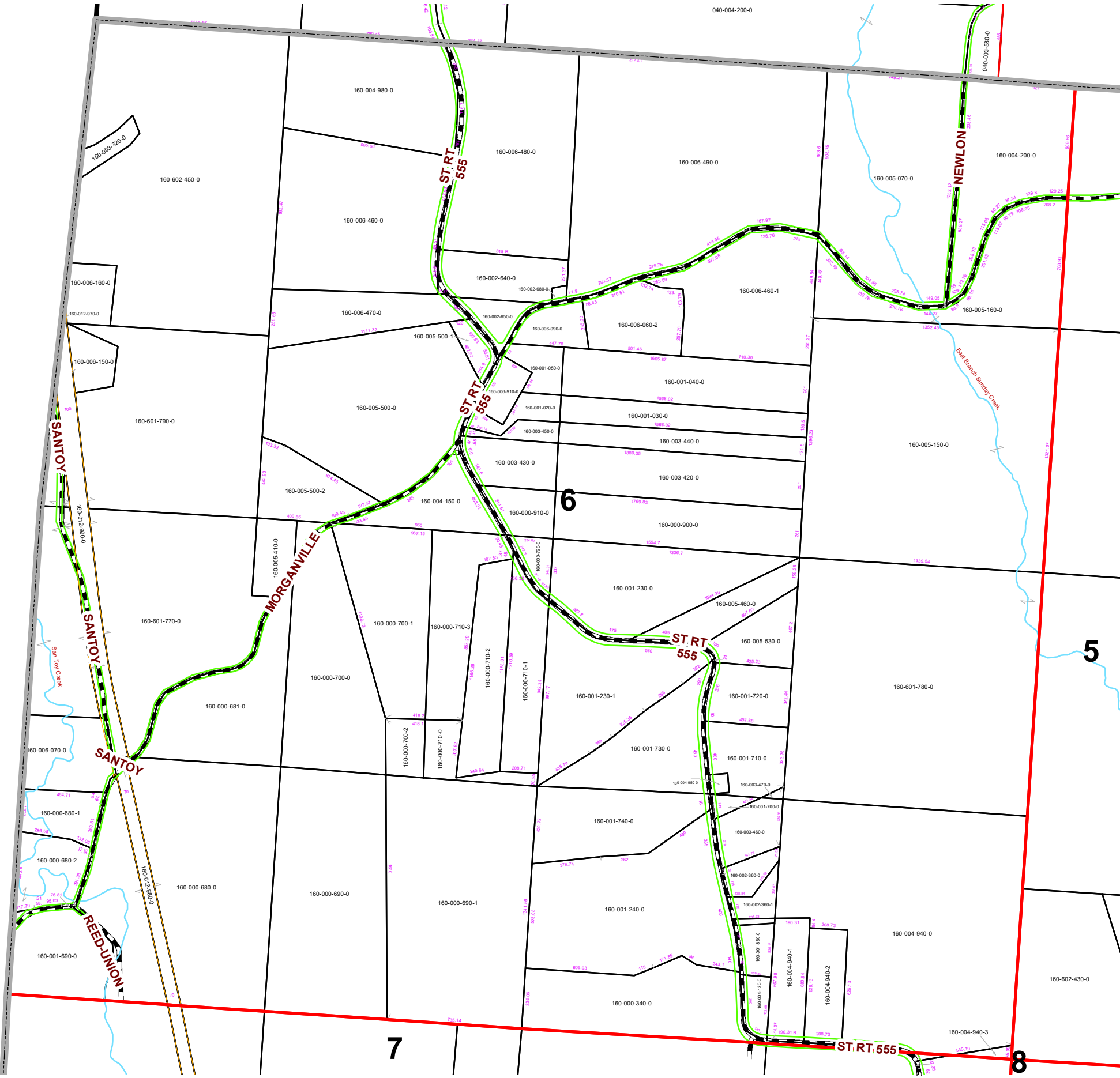

PIN	Owner	LegalDescr	Acres	VOL	PAGE	Survey_Ref
160-006-090-0	MILLER PATRICIA R	R13 T08 S06 SD 37	1.999	OR212	3204	UNN-0307.pdf
160-004-150-0	MOORE GREGORY R & AMY J	R13 T08 S06 SD 60 SUR	4.554	OR102	560	UNN-0072.pdf
160-004-940-1	MOORE HELEN	R13 T08 S06 SD 66 SUR	2.943	OR233	2684	UNN-0145.pdf
160-004-130-0	MOORE HELEN	R13 T08 S06 SD 47 EX	1.11	OR233	2684	UNN-0051.pdf
160-000-680-2	NELSON LOGAN A	R13 T08 S06 SD 78 EX	3.352	OR213	194	UNN-0235.pdf
160-002-360-0	PHILLIPS HOLLY E & WANDA J	R13 T08 S06 SD 49 SUR	1.16	OR210	3215	UNN-0305.pdf
160-005-410-0	RHODES ROBERT E ETAL C/O JEAN K	R13 T08 S06 SD 21	2	D.V 184	300	NoSurvey.pdf
160-005-460-0	RICKETTS STEVEN H ET3AL	R13 T08 S06 SD 45 EX	3.28	OR207	331	NoSurvey.pdf
160-005-500-0	ROSS JERRY L & AMY L	R13 T08 S06 SD 7 SUR	20.684	OR220	3059	NoSurvey.pdf
160-005-500-2	ROSS JERRY L & AMY LYNN	R13 T08 S06 SD 69 SUR	4.211	OR34	516	UNN-0177.pdf
160-006-070-0	STANLEY MITCHEL SR & INA G TRUST	R13 T08 S06 SD 28 EX	4.4	OR138	323	NoSurvey.pdf
160-006-470-0	SWANK THOMAS A SR & TERESA	R13 T08 S06 SD 19 EX	5.829	OR232	2735	UNN-0345.pdf
160-006-460-0	SWANK THOMAS A SR & TERESA	R13 T08 S06 SD 6 EX G	17.002	OR232	2735	UNN-0345.pdf
160-000-340-0	TOMBLIN DONALD L & DEONNAH G TR	R13 T08 S06 SD 55	10.244	OR217	485	UNN-0293.pdf
160-602-450-0	U S DEPT OF AGRICULTURE	R13 T08 S06 LOT 16 GE	84.2	D.V 104	136	NoSurvey.pdf
160-601-770-0	UNITED STATES OF AMERICA	R13 T08 S06 LOT 8	26.47			NoSurvey.pdf
160-601-780-0	UNITED STATES OF AMERICA	R13 T08 S06 LOT 13	40	D.V 92	186	NoSurvey.pdf
160-601-790-0	UNITED STATES OF AMERICA	R13 T08 S06 LOT 15	20.76	D.V 104	136	NoSurvey.pdf
160-003-420-0	VAN METER NATHAN & NIKKIA	R13 T08 S06 SD 38	8	OR232	2557	UNN-0029A.pdf
160-003-430-0	VAN METER NATHAN & NIKKIA	R13 T08 S06 SD 39	3.05	OR232	2557	UNN-0029A.pdf
160-003-450-0	VAN METER NATHAN & NIKKIA	R13 T08 S06 SD 4 EX C	1.205	OR232	2557	UNN-0067.pdf
160-003-440-0	VAN METER NATHAN & NIKKIA	R13 T08 S06 SD 5 EX C	3.955	OR232	2557	UNN-0067.pdf
160-000-720-0	WARD RONALD L & HEATHER	R13 T08 S06 SD 20	1	OR186	34	UNN-0144.pdf
160-001-700-0	WERNER LINDA S	R13 T08 S06 SD 46 EX	0.43	OR230	2620	UNN-0057.pdf
160-001-710-0	WERNER LINDA S	R13 T08 S06 SD 52 EX	3.78	OR230	2620	UNN-0057.pdf
160-001-720-0	WERNER LINDA S	R13 T08 S06 SD 53	3.32	OR230	2620	UNN-0057A.pdf
160-004-200-0	WISEMAN KENNY L TOD: CLINTON ERI	R13 T08 S06 SD 32	11.076	OR233	4568	DRF-0299.pdf
160-005-150-0	WISEMAN RICHARD T	R13 T08 S06 SD 3 EX C	40	D.V 193	651	UNN-0270.pdf
160-005-160-0	WISEMAN RICHARD T	R13 T08 S06 SD 31 EX	15	D.V 193	651	UNN-0270.pdf
160-006-490-0	WISEMAN RUSSELL E & DEE A	R13 T08 S06 SD 2 EX OI	31.34	OR234	2798	UNN-0285.pdf
160-006-480-0	WISEMAN RUSSELL E & DEE A	R13 T08 S06 SD 44 EX	19.35	OR234	2798	UNN-0285.pdf
160-005-070-0	WISEMAN RUSSELL EUGENE & DEE AN	R13 T08 S06 SD 1 SUR	19.618			UNN-0098.pdf
160-006-460-1	WOODGEARD KERRI R	R13 T8 S6 SD 79	11.46	OR235	4984	UNN-0307A.pdf

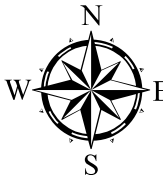

Boundaries	
	Hydro
	Section
	Roads
	Lot
	County
	Parcel
	Township
	ROW



Disclaimer: The information that these maps contains is for reference purposes only. Please bring any erros to the attention of the Engineer's Office staff. Thank you

